

Emergency Range

Installation instructions for JC50326 Recessed Exit Blade

JCC | a **LEVITON** company

Warnings & Cautions

- To avoid electric shock, serious injury or property damage, isolate power before installing, removing or servicing the product.
- It is recommended that luminaires are installed by a qualified electrician to ensure the installation complies with the local current wiring regulations.
- It may be necessary to upgrade your MCBs to allow for increased inrush current.
- This product is designed for connection to a 220-240V~ 50/60Hz.
- It is recommended that the ambient room temperature should not exceed 30°C.
- The light source of this luminaire is not replaceable: when the light source reaches the end of its life the whole of the luminaire must be replaced.
- This product is suitable for indoor use only.
- Read instructions and check that you have all of the tools and accessories required to complete the installation correctly. Isolate power supply before starting installation.
- Do not carry out insulation tests with the product connected to the circuit.
- Any broken or damaged parts should be replaced as soon as possible. JCC will not accept responsibility for claims arising from sub-standard installations; which will void the warranty.

INSTALLATION

ENGLISH

3W 220-240V~ 50/60Hz - Class II 
Colour temp: 6000K Ra: 87

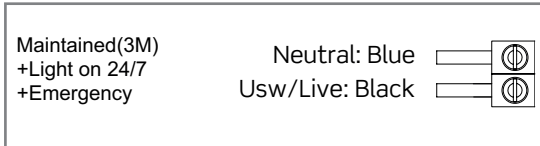

Installation procedure

1. To remove the back cover, remove the two screws from the back.
2. Cable entry is available through the rear only.
3. Cut out for installation is 320mm long by 55mm wide
4. Connect the mains input supply as indicated above for the required operation.
5. Connect the emergency battery leads to the circuit board (top right hand corner - next to the batteries).
6. Refit the body to the base and push both spring clips back and place into cut out.
7. Using the 4 press clips supplied, fit the two corresponding legends to the blade to suit the application.
8. Switch on mains supply and test for operation (allow 24hrs for batteries to charge).
9. Familiarise yourself with the enclosed emergency fittings test record sheet and ensure it is completed as required.

Function test

1. With mains supply and green indicator light on, press the Test Button to check function.
2. Green indicator light will go off and the fitting will operate in emergency mode.
3. Release the button and the indicator light will come on and the fitting will then return to previous operation.

Available legends to order:

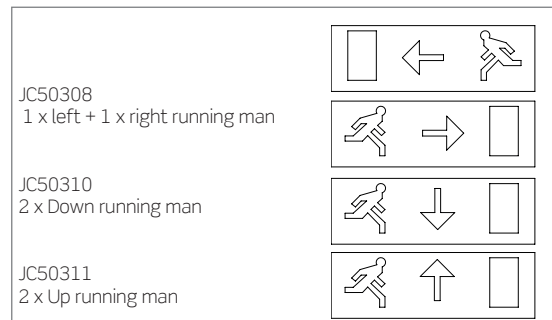

Cut out 320mm x 55mm

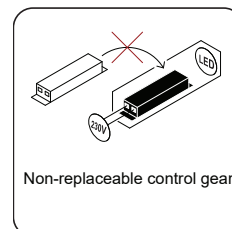
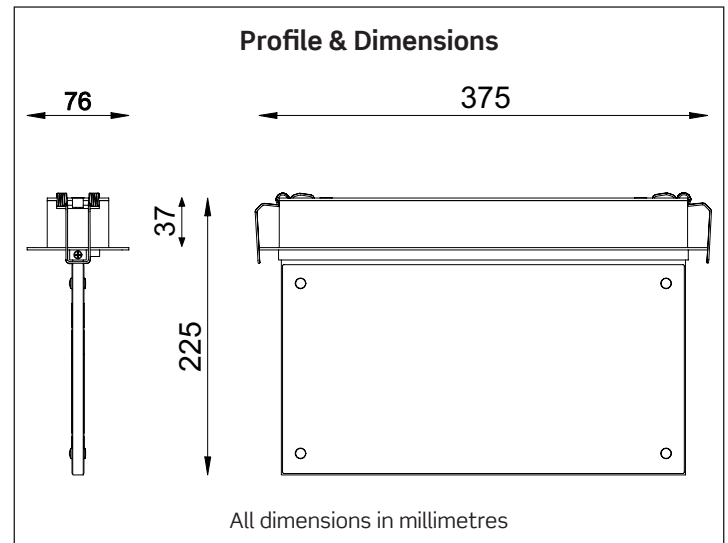

Non-replaceable control gear

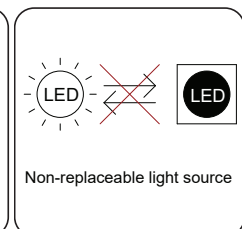

Non-replaceable light source

CE UK RoHS Compliant   IP20 **jcc.co.uk**

Important warranty information

This product is supported by a 2-year standard warranty which will extend to 3 years if registered within the first year of purchase. (2 year on batteries). Please register at jcc.co.uk/warranty - Terms and conditions apply.

The installer will be asked to provide the following information, which is detailed on a label attached to the luminaire's chassis:
Product Code/Date Code.

BS EN ISO9001 - 2015 - Registered Firm Certificate No. GB 1552

JCC Lighting Products Ltd. Innovation Centre, Beeding Close, Southern Cross Trading Estate, Bognor Regis, West Sussex, PO22 9TS, United Kingdom

Technical Support: +44(0)1243 838986 Customer Services: +44(0)1243 838999

V3_Mar_2021_RS

